

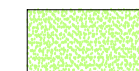





-  Prato
-  Siepe h.1.80 (fotinia - laurus nobilis)
-  Siepe h.1.30 (biancospino - ligustrum - corbezzolo)
-  Celtis australis
-  Quercus ilex

-  Palo stradale esistente h. 6.00
-  Palo di arredo urbano a LED h. 3.00

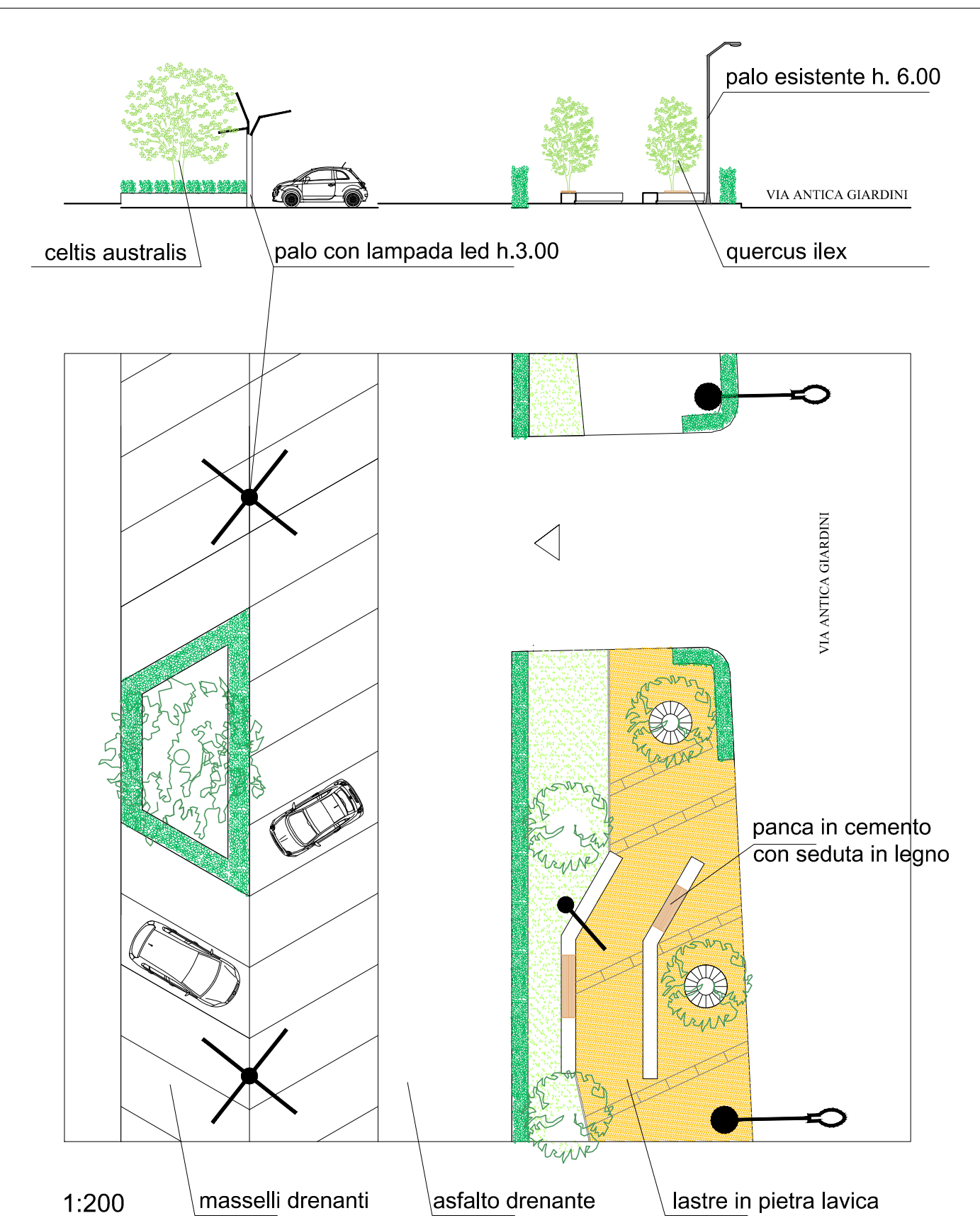
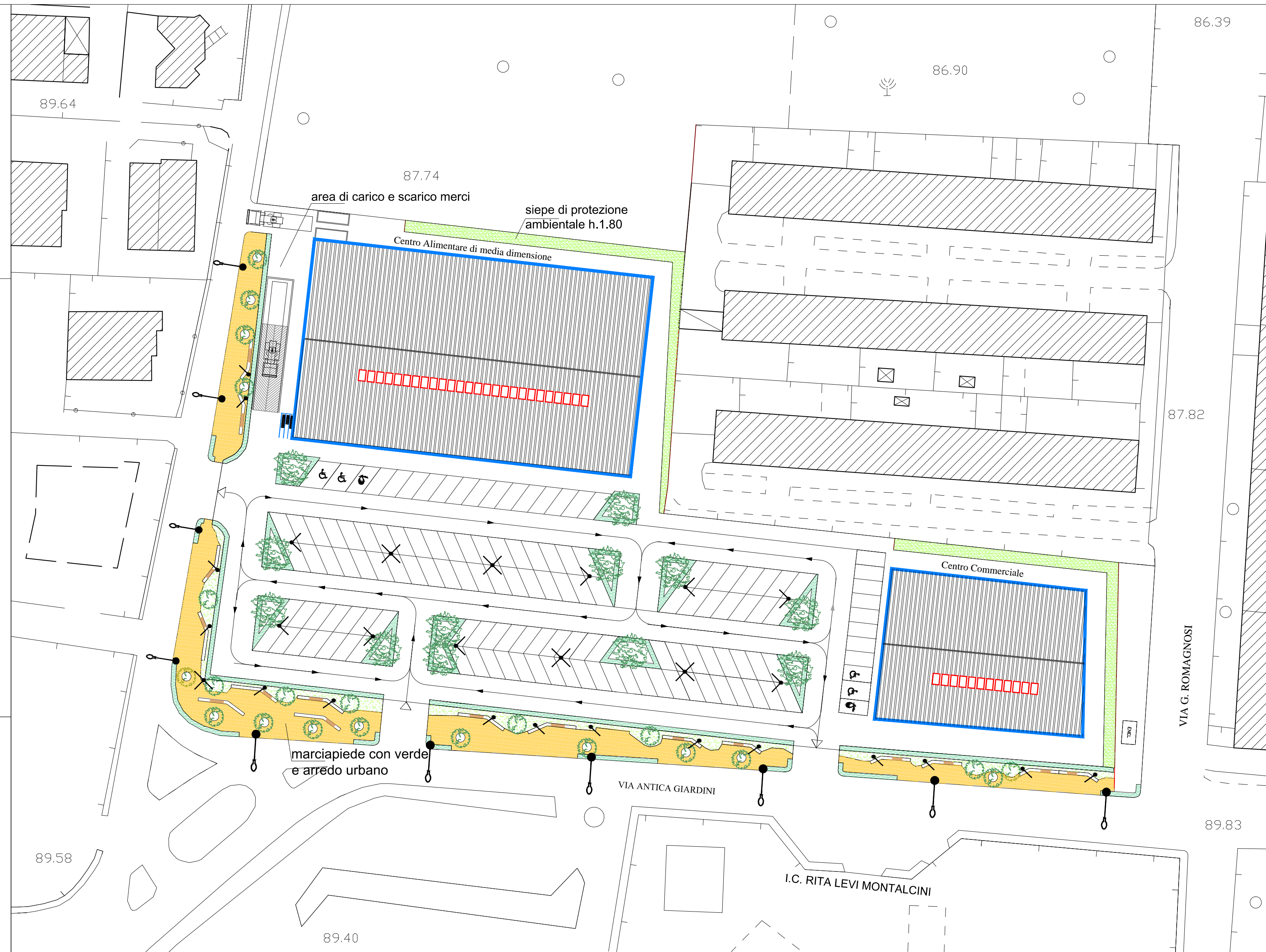

panca in cemento con seduta in legno

COMUNE DI GIUGLIANO IN CAMPANIA  
Provincia di Napoli

Piano Urbanistico Attuativo  
(L.R. 16/2004 - art. 27)  
ZONA OMOGENEA F1  
ATTREZZATURE AD USO PUBBLICO DI INIZIATIVA PRIVATA  
in Via Antica Giardini  
catasto terreni foglio 54 particella 2214

**P3**

Planovolumetrico  
Dettaglio aree di uso Pubblico  
1:500 - 1:200

richiedente: **MD** spa  
Gricignano d'Aversa  
C.F. e P.I. 03185210618  
(in persona del proprio procuratore speciale)  
dott. ing. Michele Marco Aiello

progettisti: prof. arch. Achille Renzullo

I.A. Consulting Srl

Luglio 2019

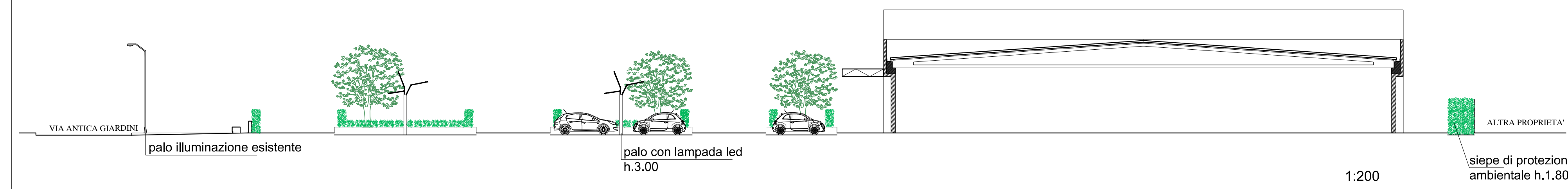

illuminazione con lampada LED



fotinia



laurus nobilis



biancospino



ligustrum



corbezzolo

**SIEPI**



celtis australis



quercus ilex